



WOOD DESTROYING PESTS AND ORGANISMS INSPECTION REPORT

| | | | |
|--|--|--|--|
| Building Address: 1550 Loma Vista, Pasadena, CA 91104 | | Date of Inspection 12/18/2025 | Number of Pages 10 |
|  <div style="display: inline-block; vertical-align: middle; text-align: left;"> Del Rio Termite & Pest Control 1508 Highland Ave. Duarte, CA 91010 Phone: (626) 930-8722 Fax: (626) 930-8723 </div> <div style="display: inline-block; vertical-align: middle; text-align: center;">  NAT-84206-1 </div> | | Report # W36636 Lic. Registration # PR 4246 Escrow # | |
| Ordered by: Sotheby's International Realty Michael Bell 800 E. Colorado Blvd. Ste 150 Pasadena, CA 91101 | Property Owner and/or Party of Interest: | | Report Sent to: Sotheby's International Realty Michael Bell 800 E. Colorado Blvd. Ste 150 Pasadena, CA 91101 |
| COMPLETE REPORT <input checked="" type="checkbox"/> LIMITED REPORT <input type="checkbox"/> SUPPLEMENTAL REPORT <input type="checkbox"/> REINSPECTION REPORT <input type="checkbox"/> | | | |
| General Description: Single story wood framed stucco siding single family residence with composition roof with detached 2 car garage. Furnished at the time of inspection. | | Inspection Tag Posted: Attic Other Tags Posted: None | |
| An inspection has been made of the structure(s) shown on the diagram in accordance with the Structural Pest Control Act. Detached porches, detached steps, detached decks and any other structures not on the diagram were not inspected. | | | |
| Subterranean Termites <input checked="" type="checkbox"/> Drywood Termites <input checked="" type="checkbox"/> Fungus / Dryrot <input checked="" type="checkbox"/> Other Findings <input type="checkbox"/> Further Inspection <input type="checkbox"/> <small>If any of the above boxes are checked, it indicates that there were visible problems in accessible areas. Read the report for the details on checked items.</small> | | | |

The drawing is located on the final page.

This Diagram is not to scale

Inspected by: David A Perez State License No. FR 65977 Signature 

You are entitled to obtain copies of all reports and completion notices on this property reported to the Structural Pest Control Board during the preceding two years. To obtain copies contact: Structural Pest Control Board, 2005 Evergreen Street, Ste. 1500, Sacramento, California 95815.

NOTE: Questions or problems concerning the above report should be directed to the manager of the company. Unresolved questions or problems with the services performed may be directed to the Structural Pest Control Board at (916) 561-8708, (800) 737-8188 or www.pestboard.ca.gov

SECOND PAGE OF STANDARD INSPECTION REPORT OF THE PROPERTY LOCATED AT:

Address 1550 Loma Vista, Pasadena, CA 91104

12/18/2025

W36636

Date

Report #

LEAD PAINT TESTING IS NOW A LAW ON ALL HOMES PRE 1978. Pre 1978 buildings. Homes and other buildings constructed prior to 1978 are presumed to have lead paint that may cause serious health issues if disturbed during repairs. Special procedures are required by the US EPA in repairing painted areas where more than 6 square feet in the interior or 20 square feet on the exterior are disturbed. Local and state requirements may be more restrictive. Those doing the repairs are required by the EPA to be licensed Lead Renovators and must follow strict testing, containment, repair, clean up and debris disposal practices. The penalties for violations of the EPA regulations are severe. You will be provided with the EPA pamphlet entitled "Renovate Right - Important Lead Hazard Information for Families..." prior to the start of repairs. You will be notified of the additional costs of compliance. If you have any questions please contact us. "Notice" The Structural Pest Control Board encourages Competitive business practice among registered companies. Reports on this structure prepared by various registered companies should list the same findings (I.e. termite infestations, termite damage, and fungus damage, etc.) However recommendations to correct these findings may vary from company to company. You have the right to seek a second opinion from another company.

"NOTICE: The charge for service that this company subcontracts to another registered company may include the company's charges for arranging and administering such service that are in addition to the direct costs associated with paying the subcontractor. You may accept Del Rio Pest Control, Inc.'s bid or you may contract directly with another registered company licensed to perform the work. If you choose to contract directly with another registered company, Del Rio Pest Control, Inc. will not in any way be responsible for any act or omission in the performance of work that you directly contract with another to perform."

Certain areas are recognized by the industry as inaccessible and/or for other reasons not inspected. These include but are not limited to: inaccessible and/or, insulated attics or portions thereof, attics with less than 18" clear crawl space, the interior of hollow walls; spaces between a floor or porch deck and the ceiling below; areas where there is no access without defacing or tearing out lumber, masonry or finished work; make inspection impractical; and areas or timbers around eaves that would require use of an extension ladder.

Slab concrete floor construction has become more prevalent in recent years. Floor coverings may conceal cracks in the slab that may allow infestations of wood destroying pests to enter. Infestations in walls may be concealed by plaster, plaster board or sheet rock so that a diligent inspection may not disclose and uncover the true condition. Subterranean termites that enter from under slab floors are not under warranty. These areas are not practical to inspect because of health hazards, damage to the structure; or it is an impractical inconvenience. They are not inspected unless described in this report. We recommend further inspection if there is any question about the areas noted. Re: Structural Pest Control Act, Article 1, Section 8516(b) Amended, effective March 1, 1974. Inspection is limited to disclose the presence of wood destroying pest and organisms as set forth in the Structural Pest Control Act, Article 1, Section 8516(b).

Important Note Regarding Subterranean Termites: Subterranean termites that appear after our original inspection are not under any guarantee by this company. Subterranean termites sometimes live in the soil under concrete slabs and can often go undetected for months or years. These termites can not be detected during our visual inspections. There will be a fee for treating any newly detected infestation.

The above areas were not inspected unless described in this report. We recommend further inspection if there is any question about the above noted areas. Re: Structural Pest Control Act, Article 6, section 8516 (b), paragraph 1990 (l). Amended effective March 1, 1974. Stall shower, if any, are water tested in compliance with Section 1991 (12) of the Structural Pest Control Act. The absence or presence of leaks through sub-floor, adjacent floors or walls will be reported. This is a report of the condition of the stall shower at the time of inspection only, and should not be confused as a guarantee. Although we make a visual examination, we do not deface or probe into window or door frames, decorative trim, roof members, etc., in search of wood destroying pests or organisms.

Note: The bid below includes Standard Readily Available Lumber. Old or Custom sized materials will be replaced with an available alternative. Custom order or special milled items will only be used when the person(s) ordering the corrective work makes a special request. All custom order or special milled items will be ordered only after the approval of additional costs.

Note: All repair bids on this report are to repair existing structures as noted on our report. It is the responsibility of the owner of this property to inform Del Rio Pest Control Inc. if some existing structure being repaired is not permitted or not built to code. It is the property owners responsibility prior to approving any repairs to check with the City Building Dept. to see if permits are required for the work estimated below. If required, the property owner will need to pull permits as an owner builder and notify Del Rio Pest Control Inc. Any additional work required by City Building Dept. and/or field inspectors will be at an additional cost.

Mold Policy Statement: Structural Pest Control Board, May 2002

Molds, sometimes called mildew, are not wood-destroying organisms. Branch 3 licensees do not have a duty under the Structural Pest Control Act and related regulations to classify molds as harmful to human health or not harmful to human health.

NOTE: We do not inspect or certify plumbing, plumbing fixtures, etc.

NOTE: "The exterior surface of the roof will not be inspected. If you want the water tightness of the roof determined, you should contract a roofing contractor who is licensed by the Contractor's State License Board." We do not inspect or certify roofs.

THIRD PAGE OF STANDARD INSPECTION REPORT OF THE PROPERTY LOCATED AT:

Address 1550 Loma Vista, Pasadena, CA 91104

12/18/2025

W36636

Date

Report #

Hidden damage is possible any time evidence of subterranean termites, drywood termites, fungus (dry rot), beetles, faulty grade, earth to wood contact, dampwood termites, shower leaks or excessive moisture is noted on this report. It is also possible for hidden damage to be present in the interior of walls, flooring and other areas that are not readily accessible for inspection. This company will not be held responsible for any hidden damage.

CONDITIONAL GUARANTEE: Del Rio Pest Control Inc. guarantees all work performed by this company for one year. This company is not responsible for any future infestation, dry rot or adverse conditions beyond the time of inspection. If fumigation is performed, Del Rio Pest Control Inc. is not liable for any damage to shrubs, vines, trees, etc. or any damage to roofs or roof members at the time of Fumigation. In the event that a re-treatment, re-fumigation or any other repair work is to be performed to honor a guarantee issued by Del Rio Pest Control Inc.; the home-owner is responsible to make the property available for any work to be performed. Del Rio Pest Control Inc. will not be liable for any cost of vacating or preparing the residence for re-treatment; and / or repairs. NOTE: A new and/or extension of guarantee is never given for re-treatments done under original guarantee. ALL LOCAL TREATMENTS ARE NOT INTENDED TO BE AN ENTIRE STRUCTURE TREATMENT METHOD. IF INFESTATIONS OF WOOD DESTROYING PESTS EXTEND OR EXIST BEYOND THE AREA (S) OF LOCAL TREATMENT THEY MAY NOT BE EXTERMINATED. ONE YEAR LIMITED GUARANTEE ON ALL TREATMENTS DONE BY THIS COMPANY.

NOTICE: Del Rio Pest Control Inc. does not warranty work performed by others. Such warranties should be obtained from those performing the repairs. Del Rio Pest Control Inc. only re-inspects the absence of infestation or infection in the visible and accessible areas. If it is found others have concealed or hidden infestations or infections during the course of their repairs, it will be the responsibility of the home-owner or buyer to pursue the responsible parties.

NOTE: SPECIFIC LIST OF AREAS WHICH HAVE NOT BEEN INSPECTED AS FOLLOWS.

This report regards the inspection of that part of the premises as identified on the drawing attached to the report. In accordance with the standard practice of pest control operators, certain structural areas are considered inaccessible for purposes of inspection, including but are not limited to: (1.) Furnished interiors (2.) Portions of attic concealed or made inaccessible by insulation and/or inadequate crawl space. (3.) The interior of hollow walls. (4.) Space between a floor or porch deck and the ceiling below. (5.) Stall showers over finished ceilings. (6.) Areas concealed by built-in cabinet work. (7.) Hardwood floor beneath linoleum, carpet, or tile. (8.) Inside kitchen or bathroom cabinets where food or supplies are stored. (9.) Areas concealed by appliances. (10.) Interiors of enclosed boxed eaves. (11.) Second story eaves where access is impractical with standard 6' foot ladder. (12.) Areas where plant growth is covering wood members. (13.) Exterior eaves and siding where access is limited due to zero lot lines, neighbors access, heavy plant growth or abutments. (14.) Fences and gates surrounding or attached to the property.

In accordance with the laws and regulation of the State of California, we are required to provide you with the following information prior to application of Termiticides to your property.

"State law requires that you be given the following information: CAUTION, PESTICIDES ARE TOXIC CHEMICALS. Structural Pest Control Companies are registered and regulated by the Structural Pest Control Board, and apply pesticides which are registered and approved for use by the California Dept. of Pesticide Regulation and the United States Environmental Protection Agency. Registration is granted when the State finds that based on existing scientific evidence there are no appreciable risks if proper use conditions are followed or that the risks are outweighed by the benefits. The degree of risk depends upon the degree of exposure, so exposure should be minimized."

"If within 24 hours following application, you experience symptoms similar to common seasonal illness comparable to the flu, contact your physician or poison control center and your pest control operator immediately." Effects of over exposure to these materials can include tremors and tonic and colonic convulsions.

For further information, contact any of the following:

| | |
|--|----------------|
| Del Rio Pest Control Inc. | (626) 930-8722 |
| Poison Control Center | (800) 876-4766 |
| Los Angeles County Health Dept. | (323) 881-4046 |
| Orange County Health Dept. | (714) 834-7700 |
| Riverside County Health Dept. | (951) 358-5000 |
| San Bernardino County Health Dept. | (800) 782-4264 |
| Los Angeles County Agriculture Commission | (626) 575-5468 |
| Orange County Agriculture Commission | (714) 955-0100 |
| Riverside County Agriculture Commission | (951) 955-3011 |
| San Bernardino Agriculture Commission | (909) 387-2105 |
| Ventura County Health Dept. | (805) 654-2813 |
| Structural Pest Control Board (Regulatory Info.) | (916) 561-8700 |
| 2005 Evergreen Street, Ste. 1500, Sacramento, CA 95815 | |

FOURTH PAGE OF STANDARD INSPECTION REPORT OF THE PROPERTY LOCATED AT:

Address 1550 Loma Vista, Pasadena, CA 91104

12/18/2025

W36636

Date

Report #

TERMITE AND FUNGUS CONTROL CHEMICALS

Bora-Care (EPA Reg. No. (EPA Reg. NO. EPA. Reg. No. 64405-1- EPA Est. 64405-TN-1))

Active Ingredients: Active Ingredients Disodium Octaborate Tetrahydrate (Na₂B₈O₁₃-4H₂O) 40%/ Other Ingredients 60%

Termidor (EPA Reg. No. (EPA Reg No. 7969-210))

Active Ingredients: Active Ingredients: Fipronil:5-amino-1-(2,6-dichlorol-4-(trifluoromethyl) phenyl)

Vikane (EPA Reg. No. 464-232)

Active Ingredients: Vikane-sulfuryl floride 99.5%, Chloropicrin .5%

Zythor Gas (EPA Reg. No. EPA Reg. No. 81824-1)

Active Ingredients: Sulfuryl Flouride 99.3%

Tim-bor (EPA Reg. No. 1624-39)

Active Ingredients: Disodium Octaborate Tetrahydrate 98%

A separated report has been requested which is defined as section I / section II conditions evident on the date of inspection. Section I contains items where there is evidence of active infestation, infection of conditions that have resulted in or from infestation of infection. Section II items are conditions deemed likely to lead to infestation or infection but where no visible evidence of such was found. Further inspection items are defined as recommendations to inspect area(s) which during the original inspection did not allow the inspector access to complete his inspection and cannot be defined as section I or section II.

FINDINGS AND RECOMMENDATIONS

Substructure:

Fair access, inspected visible and accessible areas where practical Areas not inspected were impractical for inspection due to construction. See entire report for terms and conditions.

1A PRICE: \$20.00 (Section II)

FINDINGS: Cellulose debris noted at sub area at time of inspection.

RECOMMENDATION: Clean-out cellulose debris and remove from premises.

1B PRICE: \$380.00 (Section I)

FINDINGS: Evidence of subterranean termite infestation at sub area.

RECOMMENDATION: Pressure "ROD" treat, trench application or low pressure spot spray as necessary.

Liquid solutions may be applied in the form of mist spray to exposed framing. Liquid solution may also be

injected into termites galleries where infestations are accessible. Foam solution may be applied on all

accessible wood in sub areas and garages. Remove or cover all accessible pellets and frass of wood-

destroying pests. ONE YEAR LIMITED GUARANTEE ON ALL TREATMENTS DONE BY THIS COMPANY.

NOTE: LOCAL TREATMENT IS NOT INTENDED TO BE AN ENTIRE STRUCTURE TREATMENT METHOD.

IF INFESTATIONS OF WOOD DESTROYING PESTS EXTEND OR EXIST BEYOND THE AREA (S) OF

LOCAL TREATMENT THEY MAY NOT BE EXTERMINATED. IMPORTANT NOTE REGARDING

SUBTERRANEAN TERMITES: SUBTERRANEAN TERMITES THAT APPEAR AFTER OUR ORIGINAL

INSPECTION ARE NOT UNDER ANY GUARANTEE BY THIS COMPANY. SUBTERRANEAN TERMITES

SOMETIMES LIVE IN THE SOIL UNDER CONCRETE SLABS AND CAN OFTEN GO UNDETECTED FOR

MONTHS OR YEARS. THESE TERMITES CAN NOT BE DETECTED DURING OUR VISUAL INSPECTIONS.

THERE WILL BE A FEE FOR TREATING ANY NEWLY DETECTED INFESTATION. * NOTE: HOUSE

PREVENTIVE TREATMENTS ARE AVAILABLE UPON REQUEST AND CONSIDERED A SECTION 2 ITEM.

Address 1550 Loma Vista, Pasadena, CA 9110412/18/2025W36636

Date

Report #

- Findings and Recommendations continued from previous page -

- 1C PRICE: \$2,270.00 (Section I)
FINDINGS: Evidence of dry-wood termite infestations extending to inaccessible areas at sub area
RECOMMENDATION: Vacate the premises and seal the structure for fumigation. Remove or cover accessible evidence of infestation. Fumigation warranted for two years. Fumigation awareness notice must be signed prior to fumigation. See fumigation notice for terms and liabilities. IMPORTANT INFORMATION: GAS SERVICE CLOSE AND TURN-ON ORDERS MUST BE SCHEDULED, BY CONTACTING THE UTILITIES AT THE FOLLOWING PHONE NUMBER: SO CAL GAS (800) 427-2200 THE UTILITIES REQUIRE A MINIMUM OF 48-HOURS ADVANCE NOTICE TO CLOSE GAS SERVICE. TO RESTORE GAS SERVICE, THE UTILITIES REQUIRE A 24-HOUR NOTICE UNLESS THE TURN-ON IS SCHEDULED WHEN PLACING THE SERVICE CLOSURE ORDER.
- * NOTE: DAMAGE TO PLANTS IS DEEMED LIKELY DURING THE PROCESS OF FUMIGATION. (OWNER TO SIGN PLANT RELEASE FORM)
- ** NOTE: DAMAGE TO TILE, SLATE OR ALUMINUM ROOFS ARE DEEMED LIKELY DURING THE FUMIGATION PROCESS. (OWNER TO SIGN ROOF RELEASE FORM)

- Stall Shower:** First story stall showers tested as per industry standard fifteen-minute bucket test.
- Foundations:** Concrete above grade
- Porches - Steps:** Concrete
- Ventilation:** Adequate above grade
- Abutments:** Only visible and/or accessible wood trims were inspected. Areas inaccessible behind stucco and/or plant growth were impractical to inspect and are not included. See report for terms and conditions.
- Attic Spaces:** Portions of the attic that were visible and accessible were inspected. Areas covered by insulation or construction were impractical to inspect. See report for terms and conditions.
- Garages:** Two car detached areas covered by storage were not inspected; further inspection is recommended after storage is removed.

- 8A PRICE: See 1C (Section I)
FINDINGS: Evidence of dry-wood termite infestations extending to inaccessible areas at garage
RECOMMENDATION: Vacate the premises and seal the structure for fumigation. Remove or cover accessible evidence of infestation. Fumigation warranted for two years. Fumigation awareness notice must be signed prior to fumigation. See fumigation notice for terms and liabilities. IMPORTANT INFORMATION: GAS SERVICE CLOSE AND TURN-ON ORDERS MUST BE SCHEDULED, BY CONTACTING THE UTILITIES AT THE FOLLOWING PHONE NUMBER: SO CAL GAS (800) 427-2200 THE UTILITIES REQUIRE A MINIMUM OF 48-HOURS ADVANCE NOTICE TO CLOSE GAS SERVICE. TO RESTORE GAS SERVICE, THE UTILITIES REQUIRE A 24-HOUR NOTICE UNLESS THE TURN-ON IS SCHEDULED WHEN PLACING THE SERVICE CLOSURE ORDER.
- * NOTE: DAMAGE TO PLANTS IS DEEMED LIKELY DURING THE PROCESS OF FUMIGATION. (OWNER TO SIGN PLANT RELEASE FORM)
- ** NOTE: DAMAGE TO TILE, SLATE OR ALUMINUM ROOFS ARE DEEMED LIKELY DURING THE FUMIGATION PROCESS. (OWNER TO SIGN ROOF RELEASE FORM)

- 8B PRICE: \$3,260.00 (Section I)
FINDINGS: Dry-rot wood members found at time of inspection at garage fascia boards, eaves, jambs, rafter tails, corbel and door jamb as indicated on diagram.
RECOMMENDATION: Replace/Repair dry-rot damaged wood members as necessary. Del Rio Pest Control is not responsible for any damage to roofing materials that may occur during repairs made to roof eave members. If additional adverse conditions are uncovered during repairs, further inspection will be recommended and a supplemental report will be issued indicating any infection, or additional repairs. Painting is included.
- 8C PRICE: See 8B (Section I)
FINDINGS: Evidence of termite damaged wood members noted at garage eaves, fascia boards and rafter tails at time of inspection.
RECOMMENDATION: Replace/Repair damaged wood members as necessary. Del Rio Pest Control is not responsible for any damage to roofing materials that may occur during repairs made to roof eave members. If additional adverse conditions are uncovered during repairs, further inspection will be recommended and a supplemental report will be issued indicating any infection, or additional repairs. Painting is included.

Patios-Decks: Inspection of visible and accessible wood members was made.

- 9A PRICE: \$1,680.00 (Section I)
FINDINGS: Dry-rot wood members found at time of inspection at patio planks and post as indicated on diagram.
RECOMMENDATION: Replace/Repair dry-rot damaged wood members as necessary. If additional adverse conditions are uncovered during repairs, further inspection will be recommended and a supplemental report will be issued indicating any infection, or additional repairs. Painting is included.

Interior: Inspected accessible areas only, areas covered by drywall, wall to wall carpet, furniture and or old hadwood flooring were impractical for inspection and are not included in this report, see entire report for terms and conditions.

Other Exterior: Inspected accessible areas only, see entire report for terms and conditions.

- 11A PRICE: See 1C (Section I)
FINDINGS: Evidence of dry-wood termite infestations extending to inaccessible areas at exterior
RECOMMENDATION: Vacate the premises and seal the structure for fumigation. Remove or cover accessible evidence of infestation. Fumigation warranted for two years. Fumigation awareness notice must be signed prior to fumigation. See fumigation notice for terms and liabilities. IMPORTANT INFORMATION: GAS SERVICE CLOSE AND TURN-ON ORDERS MUST BE SCHEDULED, BY CONTACTING THE UTILITIES AT THE FOLLOWING PHONE NUMBER: SO CAL GAS (800) 427-2200 THE UTILITIES REQUIRE A MINIMUM OF 48-HOURS ADVANCE NOTICE TO CLOSE GAS SERVICE. TO RESTORE GAS SERVICE, THE UTILITIES REQUIRE A 24-HOUR NOTICE UNLESS THE TURN-ON IS SCHEDULED WHEN PLACING THE SERVICE CLOSURE ORDER.

* NOTE: DAMAGE TO PLANTS IS DEEMED LIKELY DURING THE PROCESS OF FUMIGATION. (OWNER TO SIGN PLANT RELEASE FORM)

** NOTE: DAMAGE TO TILE, SLATE OR ALUMINUM ROOFS ARE DEEMED LIKELY DURING THE FUMIGATION PROCESS. (OWNER TO SIGN ROOF RELEASE FORM)

SEVENTH PAGE OF STANDARD INSPECTION REPORT OF THE PROPERTY LOCATED AT:

Address 1550 Loma Vista, Pasadena, CA 91104

12/18/2025

W36636

Date

Report #

"NOTICE: Reports on this structure prepared by various registered companies should list the same findings (i.e. termite infestations, termite damage, fungus damage, etc.). However, recommendations to correct these findings may vary from company to company. You have a right to seek a second opinion from another company.

You have the right to contract with the company of your choice. Del Rio Pest Control Inc. can provide all necessary services for the completion of the work needed for your termite clearance. After years of experience with this type of work, our company has developed a smooth system of completing the necessary repairs and termite treatments.

This company will reinspect repairs done by others within four months of the original inspection. The reinspection must be done within ten (10) working days of request. The reinspection is a visual inspection and if inspection of concealed areas is desired, inspection of work in progress will be necessary. Any guarantees must be received from parties performing repairs.

NOTE: Authority cited: Section 8525, Business and Professions Code. Reference: Section 8516, Business and Professions Code.

THE COST OF REINSPECTION IS \$95.00.

EIGHTH PAGE OF STANDARD INSPECTION REPORT OF THE PROPERTY LOCATED AT:

Address 1550 Loma Vista, Pasadena, CA 91104

12/18/2025

W36636

Date

Report #

Findings and Recommendations estimated by this Company:

| Item | Approval | Primary Estimate | Section |
|------|--------------------------|------------------|---------|
| 1A | <input type="checkbox"/> | \$20.00 | II |
| 1B | <input type="checkbox"/> | \$380.00 | I |
| 1C | <input type="checkbox"/> | \$2,270.00 | I |
| 8A | <input type="checkbox"/> | Included in 1C | I |
| 8B | <input type="checkbox"/> | \$3,260.00 | I |
| 8C | <input type="checkbox"/> | Included in 8B | I |
| 9A | <input type="checkbox"/> | \$1,680.00 | I |
| 11A | <input type="checkbox"/> | Included in 1C | I |
| 11B | <input type="checkbox"/> | \$1,870.00 | I |
| 11C | <input type="checkbox"/> | Included in 11B | I |

☐ Complete all of the items quoted above with Primary Estimate.

Total Estimate \$9,480.00

☐ Complete only the above Items checked.

Total \$ _____

*I have read and understand the terms of the Report referenced above and agree to the terms and conditions set forth.
Del Rio Pest Control is hereby authorized to complete the Items selected above and it is agreed that payment shall be made as follows:*

Payment shall be made as follows: ☐ With close of Escrow ☐ \$ _____ Deposit ☐ \$ _____ on Completion

Escrow Number: _____ Escrow Company: _____ Escrow Officer: _____

Phone () _____ - _____ Email: _____ Address: _____

Owner or Authorized Representative: ☐ Owner ☐ Representative's Title: _____

Print Name: _____ X _____ Date _____

Owner or Authorized Representative: ☐ Owner ☐ Representative's Title: _____

Print Name: _____ X _____ Date _____

Address 1550 Loma Vista, Pasadena, CA 91104

12/18/2025

W36636

Date

Report #

This Diagram is not to scale

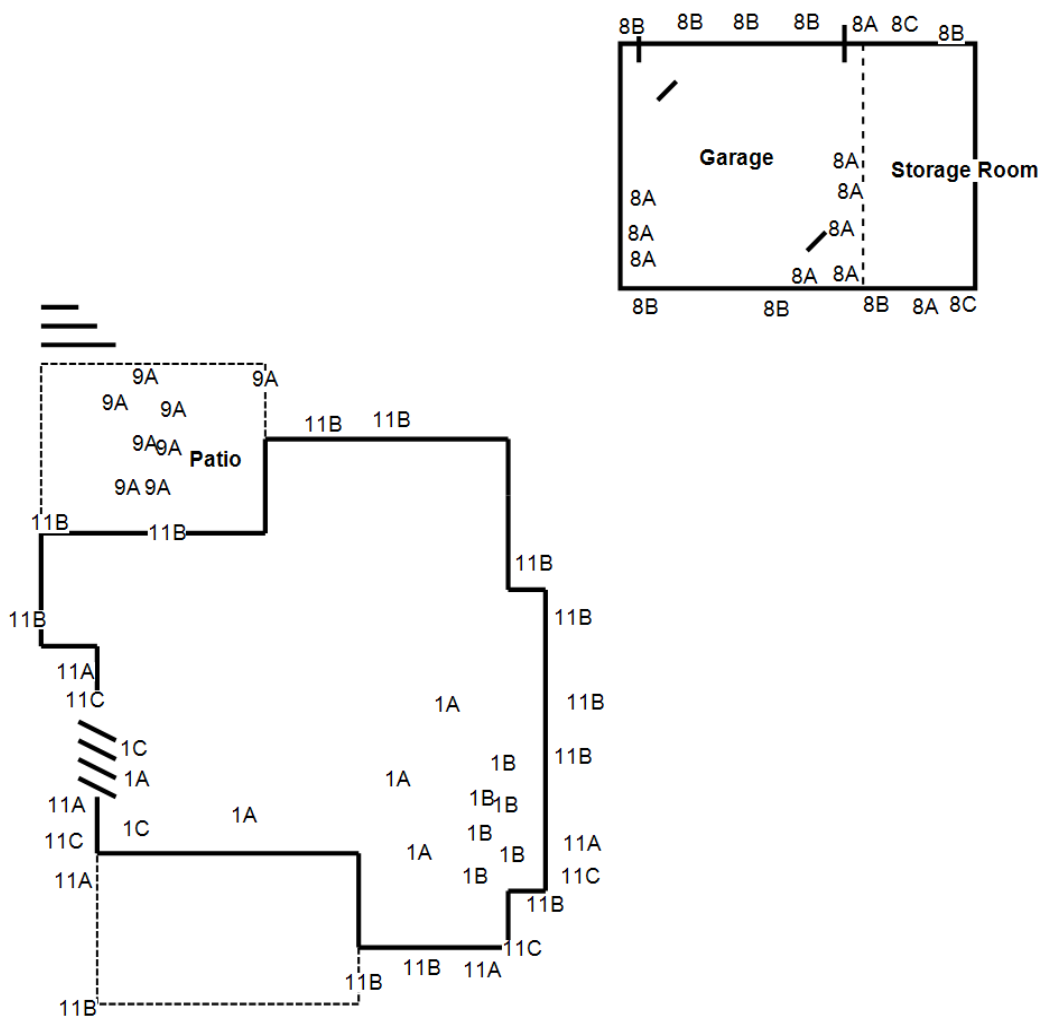



Del Rio Termite & Pest Control
1508 Highland Ave. Duarte, CA 91010
Phone: (626) 930-8722 Fax: (626) 930-8723



NAT-84206-1

Work Authorization

Page 1 of 1

Address: 1550 Loma Vista Pasadena, CA 91104

Report # W36636

Report Date: 12/18/2025

The terms of this contract are agreed upon as set forth in the above noted report.

Findings and Recommendations estimated by this Company:

| Item | Approval | Primary Estimate | Section |
|------|--------------------------|------------------|---------|
| 1A | <input type="checkbox"/> | \$20.00 | II |
| 1B | <input type="checkbox"/> | \$380.00 | I |
| 1C | <input type="checkbox"/> | \$2,270.00 | I |
| 8A | <input type="checkbox"/> | Included in 1C | I |
| 8B | <input type="checkbox"/> | \$3,260.00 | I |
| 8C | <input type="checkbox"/> | Included in 8B | I |
| 9A | <input type="checkbox"/> | \$1,680.00 | I |
| 11A | <input type="checkbox"/> | Included in 1C | I |
| 11B | <input type="checkbox"/> | \$1,870.00 | I |
| 11C | <input type="checkbox"/> | Included in 11B | I |

☐ Complete all of the items quoted above with Primary Estimate.

Total Estimate \$9,480.00

☐ Complete only the above Items checked.
Total \$ _____

I have read and understand the terms of the Report referenced above and agree to the terms and conditions set forth.

Del Rio Pest Control is hereby authorized to complete the Items selected above and it is agreed that payment shall be made as follows:

Payment shall be made as follows: ☐ **With close of Escrow** ☐ \$ _____ **Deposit** ☐ \$ _____ **on Completion**

Escrow Number: _____ Escrow Company: _____ Escrow Officer: _____

Phone () _____ - _____ Email: _____ Address: _____

Owner or Authorized Representative: ☐ Owner ☐ Representative's Title: _____

Print Name: _____ X _____ Date _____

Owner or Authorized Representative: ☐ Owner ☐ Representative's Title: _____

Print Name: _____ X _____ Date _____